

**AIRFLOW**  
by baqcool

**baqcool**

User Manual

### Important Notice

#### Warning

- This mask only filters PM 2.5, pollen, bacteria and other solid particles in smog and is not a substitute to an industrial respirator. Do not use this respirator to protect from toxic gasses, chemical fumes, etc. If you have difficulty breathing or feel unwell, please leave the polluted environment as soon as possible and take off your mask.
- To protect the wearer, wear the mask properly and make sure it fits well with the face. Avoiding whiskers, sideburns, scars or other objects between the mask and the user's face.
- If the filter element is damaged or soiled, or you have difficulty to breathing during use, please discard and replace the filter element immediately.
- Remove the mask immediately if you notice any allergic reaction.
- Do not store or leave the mask in a very high or very low temperature environment (>60°C or <20°C), such as in the car exposed to the sun. It may cause irreversible damage and compromise.
- Lithium polymer battery is built into the fan module. Improper use or storage can lead to battery leakage or fluid leakage and even cause fire.
- Please use the original TYPE-C connector for charging. Use the charger certified by CCC to charge. Pay attention that the charging input voltage does not exceed 5V.
- Please avoid damaging or puncturing the fan assembly. Do not flush fan assembly, soak the fan in water or other detergent. It may cause fan damage or electricity damage to the inside of the pool. Do not use the fan even if it still works.

If you have any of the following conditions, please consult your doctor and medical device manufacturer before using the product.

- Any respiratory illness or if you are pregnant.
- Electromagnetic fields generated by magnets and masks may interfere with medical devices such as cochlear implants.
- If you suspect interference between the fan and the medical device, please stop using it immediately.

#### Attention

- The size of this product is not suitable for children. The mask is not a toy, please do not let children play with it.
- The operating ambient temperature of the electric mask is -10°C to 40°C. The mask will stop working if it exceeds the appropriate temperature range.
- The appropriate charging ambient temperature of the electric mask is 10°C to 35°C. Beyond the temperature range, the mask may charge slowly or fail to charge.
- Condensed water on the electric mask is normal and does not affect its functional air. Dry the mask in a cool dry place when you stop using it.
- Please use the original fan assembly of AirFlow in combination with the replaceable casing and filter element. Otherwise, it cannot be guaranteed to fit and filter properly. Do not use the replaceable casing alone, otherwise no filtering will occur.
- Because of the sealed packaging, the filter element itself may contain a very small amount of raw material odor. The odor is harmless to human.
- This product is considered as a hygiene product. It must not be shared with others.

### Product Overview

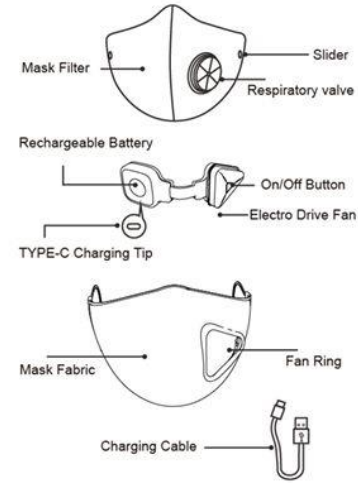

### Install

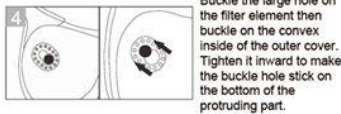
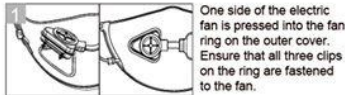

### Cleaning & Maintenance

#### The Parts of Fan

- Before cleaning, make sure the fan assembly is turned off and not connected to any power supply.
- If cleaning is required, wipe the surface with a soft wet cloth or a wet paper towel. Do not flush the surface with water.

#### The Fabric Cover

- Fabric covers can be reused and cleaned. Before cleaning, make sure the cover is separated from the fan component and filter element.
- Wipe the surface with a soft damp cloth or soak in water and gently wash by hand with a neutral detergent.
- Fabric enclosures are replaceable accessories. Different colors can be purchased.

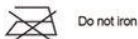
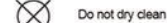
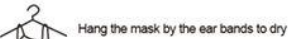
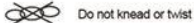
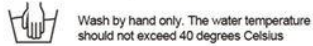

### Warranty and Service

The free warranty service does not cover the cost of consumable parts such as mask filter element and outer cover nor shipping costs. The manual serves as your warranty.

#### Free services will not be available in the following cases

- Artificial damage caused by improper use, such as improper access to power supply, improper use of instructions, improper use or negligence, etc. Damage caused by transportation and other accidents is not repaired or modified by the company. Damage caused by other force majeure (such as natural disaster, abnormal voltage, etc.).
- Damage caused by non-household use (eg industrial, commercial use).
- Normal use of the product caused by aging, wear and tear, but does not affect the normal use of the product.
- The warranty certificate, as a guarantee of free maintenance within the specified period and conditions, does not limit the legal rights of consumers.

Product : Intelligent fan mask  
Rate: 0.8W  
Charging Voltage: 5V  
Filter Material Level: N95 / KN95  
The Fabric Cover: Polyester Thermoplastic Yarn  
Grade A Qualified Product  
Do not wash electric parts and filter elements  
Fabric cover maintenance label:



Place of Production: Shenzhen China

#### Notice:

Before first use, be sure to charge the battery until the green light turns on.

The suitable charging environment temperature is 10-35°C. Each charge takes about three hours.

When the battery is low, the electric fan will change in the wind speed, prompting the need for charging.

The use time will be shortened in a low temperature environment.